

SITE EXTENT (AS PER DOCUMENT) : 648 SQ.M
ROAD AREA : 102 SQ.M
NO. OF PLOT : 1 NO.

NOTE :

☐ ROAD AREA - WAS HANDED OVER TO THE LOCAL BODY VIDE GIFT DEED DOCUMENT NO. 14955/2024, DATED:24.12.2024 @ SRO, CHENNAI SOUTH JOINT 1.

CONDITIONS :

(I) TNCDBR-2019, RULE NO:47 (11)

THE COST OF LAYING IMPROVEMENTS TO THE SYSTEMS IN RESPECT OF ROAD, WATER SUPPLY, SEWERAGE, DRAINAGE OR ELECTRIC POWER SUPPLY THAT MAY BE REQUIRED AS ASSESSED BY THE CONCERNED AUTHORITY, NAMELY, THE LOCAL BODY AND TAMIL NADU ELECTRICITY BOARD, SHALL BE BORNE BY THE APPLICANT.

(II) THE APPLICANT IS RESPONSIBLE FOR THE SHAPE, SIZE & DIMENSIONS OF THE SITE UNDER REFERENCE.

☉ NECESSARY SPACE FOR BUILDING LINE TO BE LEFT AS PER THE RULE IN FORCE WHILE TAKING UP DEVELOPMENT IN EVERY PLOT.

LEGEND:

- ☐ SITE BOUNDARY
- ☐ ROAD GIFTED TO LOCAL BODY
- ☐ EXISTING ROAD

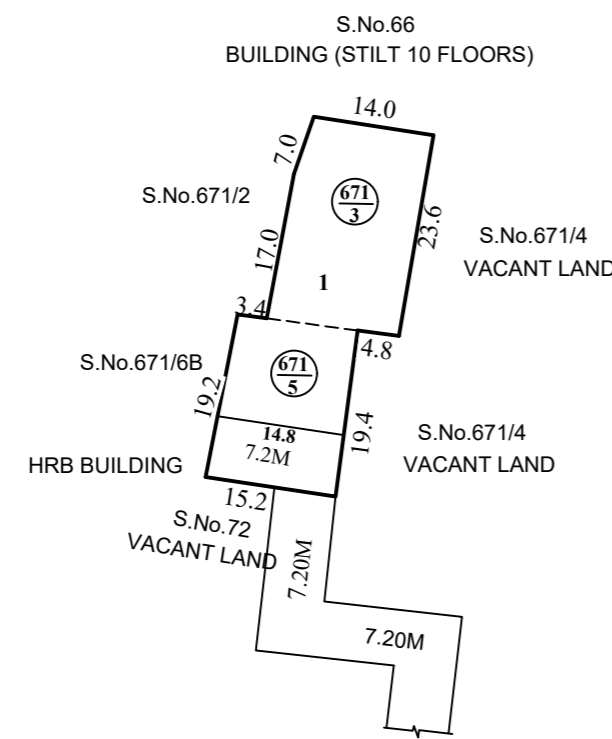

CONDITIONS:

THE SUBDIVISION APPROVED IS VALID SUBJECT TO OBTAINING SANCTION FROM THE LOCAL BODY CONCERNED.

P.P.D NO : **304**
L.O **2024**

APPROVED

VIDE LETTER NO : LAYOUT-1 / 284 / 2024

DATE : 31 / 12 / 2024

OFFICE COPY

FOR CHIEF PLANNER (LAYOUT)
 CHENNAI METROPOLITAN
 DEVELOPMENT AUTHORITY



This Planning Permission Issued under New Rule TNCDBR.2019 is subject to final outcome of the W.P(MD) No.8948 of 2019 and WMP (MD) Nos. 6912 & 6913 of 2019.

GREATER CHENNAI CORPORATION

SUB DIVISION OF HOUSE SITES IN S.Nos: 671/3, 671/5 OF PALLIKARANAI VILLAGE.

SCALE - 1:800 (ALL MEASUREMENTS ARE IN METRE)