



SITE EXTENT (AS PER DOCUMENT) : **3450 SQ.M**
ROAD AREA : **1605 SQ.M**
PUBLIC PURPOSE AREA (1%) : **20 SQ.M**
 (P.P-1 HANDED OVER TO THE LOCAL BODY 0.5% AREA : 10.0 SQ.M)
 (P.P-2 HANDED OVER TO THE TANGEDCO 0.5% AREA : 10.0 SQ.M)
NO.OF.PLOTS : **14 Nos.**





NOTE:

- SPLAY-1.5MX1.5M
- MEASUREMENTS ARE INDICATED EXCLUDING SPLAY DIMENSION
- | | | |
|---|---|--|
|  | ROAD AREA | } WERE HANDED OVER TO THE LOCAL BODY VIDE GIFT DEED DOCUMENT NO. 2036/2024, DATED: 22.02.2024, @ SRO REDHILLS. |
|  | PUBLIC PURPOSE AREA-1 | |
|  | PUBLIC PURPOSE AREA-2 (RESERVED FOR TANGEDCO) | |

CONDITIONS :

- (I) TNCDDBR-2019, RULE NO: 47 (11)
 THE COST OF LAYING IMPROVEMENTS TO THE SYSTEMS IN RESPECT OF ROAD, WATER SUPPLY, SEWERAGE, DRAINAGE OR ELECTRIC POWER SUPPLY THAT MAY BE REQUIRED AS ASSESSED BY THE CONCERNED AUTHORITY, NAMELY, THE LOCAL BODY AND TAMIL NADU ELECTRICITY BOARD, SHALL BE BORNE BY THE APPLICANT.
- (II) THE APPLICANT IS RESPONSIBLE FOR THE SHAPE, SIZE & DIMENSIONS OF THE SITE UNDER REFERENCE
- NECESSARY SPACE FOR BUILDING LINE TO BE LEFT AS PER THE RULE IN FORCE WHILE TAKING UP DEVELOPMENT IN EVERY PLOT

LEGEND:

-  SITE BOUNDARY
-  ROADS GIFTED TO LOCAL BODY
-  EXISTING ROAD
-  PUBLIC PURPOSE-1 GIFTED TO LOCAL BODY
-  PUBLIC PURPOSE-2 GIFTED TO LOCAL BODY (FOR TANGEDCO)

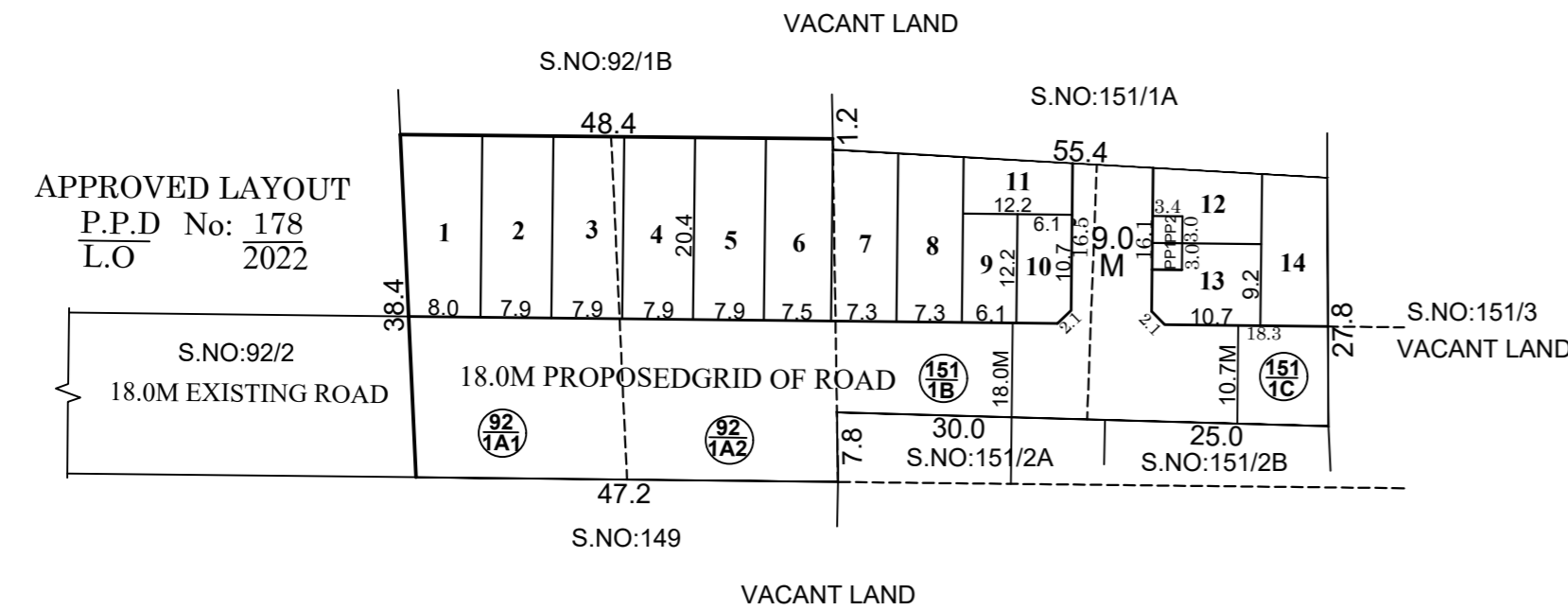

This Planning Permission Issued under New Rule TNCDDBR.2019 is subject to final outcome of the W.P(MD) No.8948 of 2019 and WMP (MD) Nos. 6912 & 6913 of 2019.

CONDITION:
 THE LAYOUT APPROVED IS VALID SUBJECT TO OBTAINING SANCTION FROM THE LOCAL BODY CONCERNED.

P.P.D NO : **45**
L.O : **2024**

APPROVED
VIDE LETTER NO : **LAYOUT-1 / 0307 / 2023**
DATE : **5 / 03 / 2024**

OFFICE COPY
 FOR CHIEF PLANNER (LAYOUT)
 CHENNAI METROPOLITAN
 DEVELOPMENT AUTHORITY

PUZHAL PANCHAYAT UNION
LAYOUT OF HOUSE SITES IN S.Nos: 92/1A1, 1A2, 151/1B, 1C OF
VILANGADUPAKKAM VILLAGE.

SCALE : 1:800 (ALL MEASUREMENTS ARE IN METRE.)

