

SITE EXTENT (AS PER PATTA) = 2008 SQ.M
ROAD AREA = 563 SQ.M
NO.OF PLOTS = 8 Nos.

NOTE:

1. SPLAY - 1.5M x 1.5M
2. MEASUREMENTS ARE INDICATED EXCLUDING SPLAY DIMENSIONS
3.  ROAD AREA TO BE HANDED OVER TO THE LOCAL BODY VIDE GIFT DEED
 DOC. NO: 3340 / 2024, DATED: 19.03.2024 @ SRO, SELAIYUR

CONDITIONS:



(I) TNCDBR-2019, RULE NO: 47 (11)

THE COST OF LAYING IMPROVEMENTS TO THE SYSTEMS IN RESPECT OF ROAD, WATER SUPPLY, SEWERAGE, DRAINAGE OR ELECTRIC POWER SUPPLY THAT MAY BE REQUIRED AS ASSESSED BY THE CONCERNED AUTHORITY, NAMELY, THE LOCAL BODY AND TAMIL NADU ELECTRICITY BOARD, SHALL BE BORNE BY THE APPLICANT.

(II) THE APPLICANT IS RESPONSIBLE FOR THE SHAPE, SIZE & DIMENSIONS OF THE SITE UNDER REFERENCE.

⊙ NECESSARY SPACE FOR BUILDING LINE TO BE LEFT AS PER THE RULE IN FORCE WHILE TAKING UP DEVELOPMENT.

LEGEND:

-  SITE BOUNDARY
-  ROAD GIFTED TO LOCAL BODY
-  EXISTING ROAD

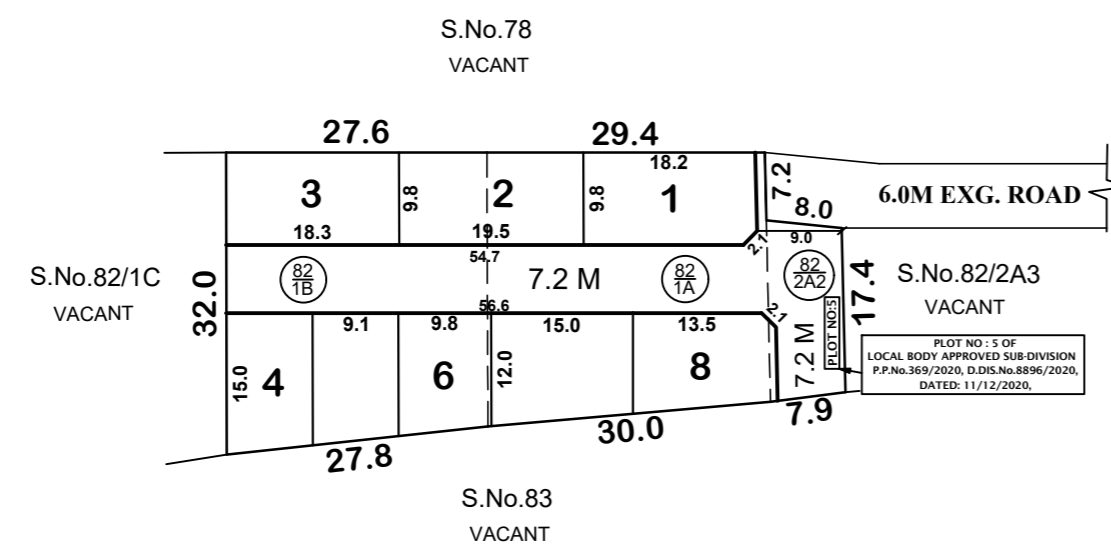

CONDITIONS:

THE SUB-DIVISION APPROVED IS VALID SUBJECT TO OBTAINING SANCTION FROM THE LOCAL BODY CONCERNED.

P.P.D NO : 66
L.O 2024

APPROVED

VIDE LETTER NO : LAYOUT-1 / 0194 / 2023

DATE : 05 / 04 / 2024

OFFICE COPY

**FOR CHIEF PLANNER (LAYOUT)
 CHENNAI METROPOLITAN
 DEVELOPMENT AUTHORITY**

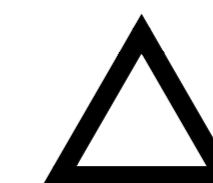

ST.THOMAS MOUNT PANCHAYAT UNION

SUB-DIVISION OF HOUSE SITES IN S.No: 82 / 1A, 1B, 2A2 (S.NO.82/2A2, PLOT NO:5 COMPRISED IN

LOCAL BODY APPROVED SUB-DIVISION P.P.No: 369 / 2020) OF ARASANKALANI VILLAGE.

SCALE : 1:800 (ALL MEASUREMENTS ARE IN METRE)

This Planning Permission Issued under New Rule TNCDBR.2019 is subject to final outcome of the W.P(MD) No.8948 of 2019 and WMP (MD) Nos. 6912 & 6913 of 2019.