

**NOTE:**

- 1) A SPLAY AT THE INTERSECTION OF TWO OR MORE STREETS / ROADS AND STREET ALIGNMENTS BE PROVIDED AS PER THE DEVELOPMENT REGULATIONS OF CMA.
- 2) GREATER CHENNAI CORPORATION TO ENSURE THAT ALL THE ROADS ARE VESTED WITH THEM AS PER THE GOVERNMENT ORDERS.

**CONDITIONS:**

- 1) As per G.O.(ms).no.78 h & ud ud4 (3) department dt. 04.05.2017 and G.O. (Ms). No. 172 H & UD(UD4 (3) dept. dated. 13.10.2017the individual plots to be regularized separately after approval of lay out framework subject to satisfaction of site dimension / extent.
- 2) Only those unapproved layouts where in a part or full number of plots have been sold through a registered sale deed as on 20th October 2016 shall be Considered for regularization under these rules.
- 3) As per G.O.(Ms).No:172 H & UD (UD4 (3) Dept dt.13.10.2017 OSR charges are exempted for the plots sold on or before 20.10.2016.
- 4) Plot or Layout in part or whole, which is located in Public water body like channel / canal etc.,shall not be eligible for regularization.
- 5) The Local Body shall regularise the individual plot by considering the least extent of ownership documents i.e., patta & sale deed document.
- 6) As per G.O.(Ms).No.78 H & UD ( UD4 (3) Dept dt. 04.05.2017and G.O. (Ms). No.172 H & UD(UD4 (3) dept. dated.13.10.2017, Rule 4 (7) the lands below the alignment of height tension and extra high voltage electric line including tower line not to be Regularised, hence required buffer zone has to be provided before regularization of individual plots in the layout under reference.

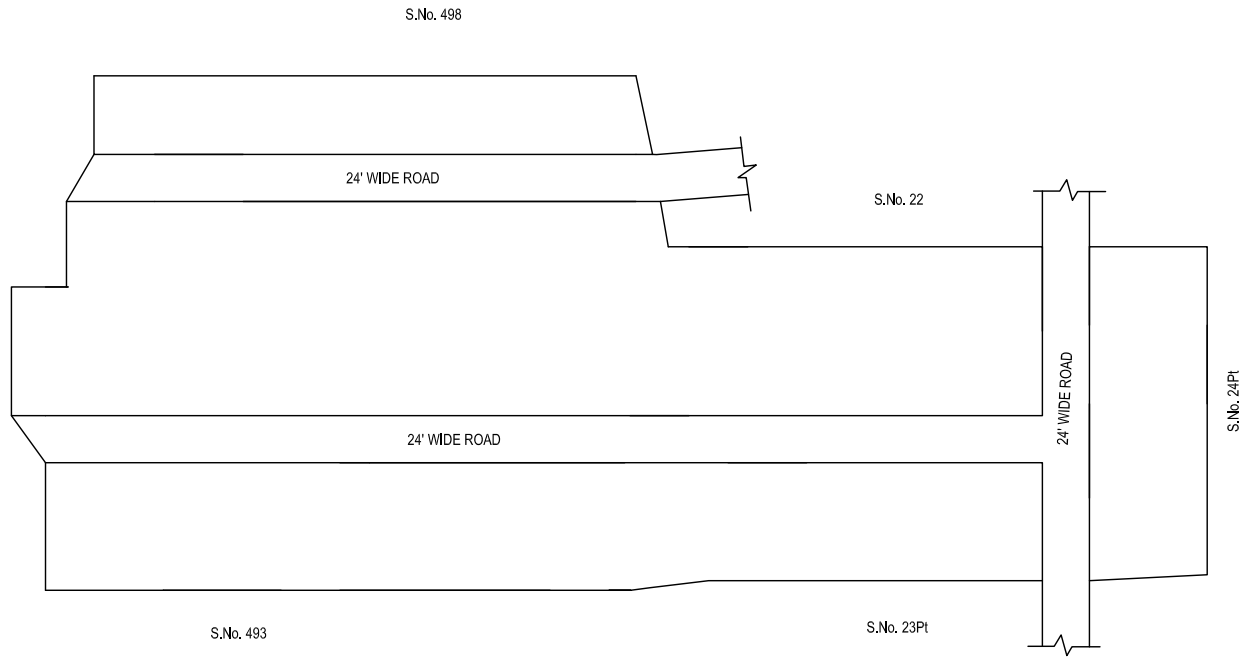

**LEGEND**

|  |                 |
|--|-----------------|
|  | LAYOUT BOUNDARY |
|  | ROAD            |
|  | EXG. ROAD       |

|  |
|--|
| <p><b>P.P.D</b> (Regularization NO : <b>1168</b><br/> <b>L.O</b> 2017) <b>2018</b></p> <p><b>APPROVED</b></p> <p>VIDE LETTER NO : Reg.L /10450/ 2018<br/>             DATE : / 07/ 2018</p> <p><b>OFFICE COPY</b></p> <p>FOR MEMBER SECRETARY<br/>             CHENNAI METROPOLITAN<br/>             DEVELOPMENT AUTHORITY</p> |
|--|

**IN-PRINCIPLE APPROVAL OF LAYOUT FRAMEWORK IN S.No:23 PT,24 PT,&497 AT KORATTUR VILLAGE OF GREATER CHENNAI CORPORATION AS PER G.O.(Ms) No:78 H&UD UD4 (3) DEPT. DT:04.05.2017 AND G.O.(Ms) No:172 H&UD UD4 (3) DEPT. DT:13.10.2017**

SCALE : 1" = 66' (ALL MEASUREMENTS ARE IN FEET)

