

AREA STATEMENT

TOTAL EXTENT	:	130680 SQ.FT
ROAD AREA	:	33756 SQ.FT
PLOTTABLE AREA	:	96924 SQ.FT
SOLD OUT AREA	:	88424 SQ.FT
UNSOLD AREA	:	8500 SQ.FT
10% OF THE TOTAL AREA OF UN SOLD PLOTS REQUIRED FOR OSR	:	850 SQ.FT
OSR PROVIDED	:	900 SQ.FT
PLOT No-103 RESERVED FOR OSR	:	01 Nos
SOLD PLOTS	:	115 Nos
UN SOLD PLOTS	:	13 Nos
TOTAL NO. OF PLOTS	:	129 Nos





NOTE:

1. A SPLAY AT THE INTERSECTION OF TWO OR MORE STREETS / ROADS SHALL BE PROVIDED AS PER DR 29.
2. ROAD AREA 33756 SQFT AND PARK AREA 900 SQFT GIFTED TO THE COMMISSIONER, SHOLAVARAM PANCHAYAT UNION, VIDE GIFT DEED DOCUMENT NO. 6898/ 2018 DATED 16.08.2018

CONDITIONS:

- 1) As per G.O.(ms).no.78 H & UD UD4 (3) department dt. 04.05.2017 and G.O. (Ms). No. 172 H & UD(UD4 (3) dept. dated. 13.10.2017 the individual plot to be regularised separately after approval of lay out framework
- 2) only those unapproved layouts where a part or full number of plots have been sold through a registered sale deed as on 20 th October 2016 shall be Considered for regularization under these rules.
- 3) As per G.O.(Ms).No.172H & UD (UD4 (3) Dept dt. 13.10.2017 OSR charges are exempted for the plots sold on or before 20.10.2016.
- 4) Plots / Sub-divisions / Layouts shall be regularised under these rules only for "Residential Usage"

LEGEND

-  LAYOUT BOUNDARY
-  ROAD
-  PARK
-  SOLDOUT PLOTS
-  UNSOLD PLOTS

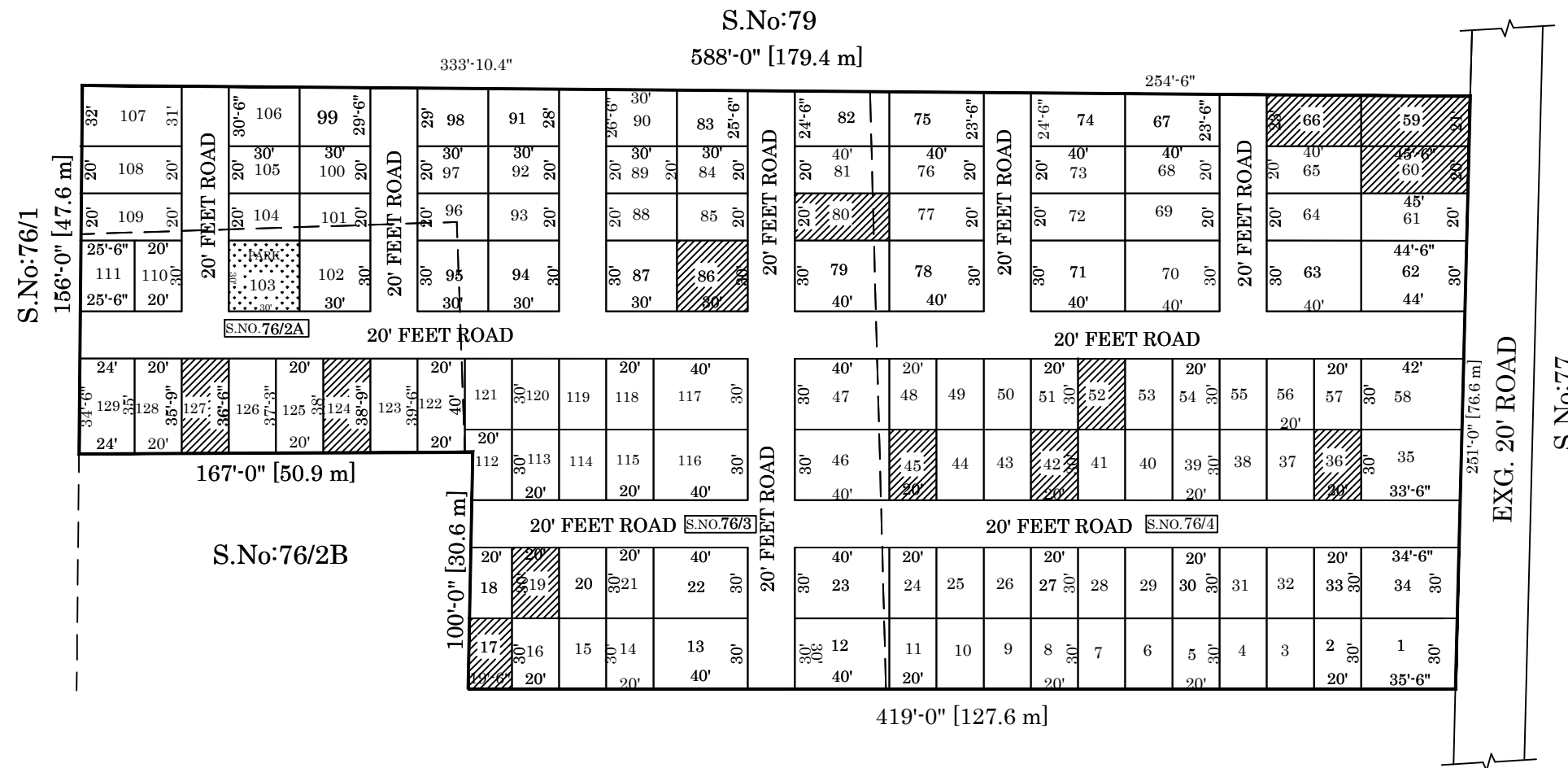

REGULARISATION OF LAYOUT FRAMEWORK IN S.No: 76/ 2A, 3 & 4 AT GIRUTHALAPURAM- ORAKKADU VILLAGE OF SHOLAVARAM PANCHAYT UNION AS PER G.O.(Ms) No:78 H&UD UD4 (3) DEPT. DT:04.05.2017 AND G.O.(Ms) No:172 H&UD UD4 (3) DEPT. DT:13.10.2017

(ALL MEASUREMENTS ARE IN FEET)

P.P.D (Regularisation NO : 1796 / L.O 2017) 2018

APPROVED
VIDE LETTER NO : Reg.L / 7556 / 2018
DATE : 10 / 09 / 2018

OFFICE COPY
FOR MEMBER SECRETARY
CHENNAI METROPOLITAN
DEVELOPMENT AUTHORITY

