

AREA STATEMENT

TOTAL EXTENT	:	25700	SQ.FT
ROAD AREA	:	4766	SQ.FT
PLOTTABLE AREA	:	20934	SQ.FT
SOLD OUT AREA	:	9664	SQ.FT
UNSOLD AREA	:	11270	SQ.FT
10% OF THE TOTAL AREA OF UN SOLD PLOTS REQUIRED FOR OSR	:	1127	SQ.FT
OSR PROVIDED	:	1169	SQ.FT
UNSOLD AREA (EXCLUDING 10% OF OSR)	:	10101	SQ.FT.
SOLD PLOTS	:	06	Nos
UN SOLD PLOTS	:	07	Nos
TOTAL NO. OF PLOTS	:	13	Nos

NOTE:

1. A SPLAY AT THE INTERSECTION OF TWO OR MORE STREETS / ROADS SHALL BE PROVIDED AS PER TNCDBR RULE 47.
2. ROAD AREA 4766 SQ.FT. AND PARK AREA 1169 SQ.FT. GIFTED TO THE EXECUTIVE OFFICER, KUNDRATHUR TOWN PANCHAYAT VIDE GIFT DEED DOCUMENT NO. 16172/2019 DATED 03.10.2019

CONDITIONS:

- 1) As per G.O.(Ms).No.78 H & UD UD4 (3) department dt. 04.05.2017 and G.O. (Ms). No. 172 H & UD(UD4 (3) dept. dated. 13.10.2017 the individual plot to be regularised separately after approval of lay out framework
- 2) As per this Office No.15/2018 dt.12.12.2018 the In-Principle Layout framework approved. In principle approval for the layout frame work for regularizing individual plots may be considered only with reference to connectivity of layout to the public road and internal road pattern.
- 3) Only those unapproved layouts where a part or full number of plots have been sold through a registered saledeed as on 20 th October 2016 shall be Considered for regularization under these rules.
- 4) As per G.O.(Ms).No.172H & UD (UD4 (3) Dept dt. 13.10.2017 OSR charges are exempted for the plots sold on or before 20.10.2016.
- 5) Plots / Sub-divisions / Layouts shall be regularised under these rules only for "Residential Usage" and subject to connectivity of layout to the public road and internal road pattern, shall be ensured by the local body.
- 6) The Local Body should ensure the layout sketch has transformed into gorund as a layout and its existance, and also conformity with the Government orders.The Shape and dimension of the layout framework is based on the sketch furnished by the applicant which was forwarded by the local body to CMDA. Hence any variation in the dimension and extent has to sorted out with respect to the FMB of the site by local body and the applicant.

LEGEND

	LAYOUT BOUNDARY
	ROAD
	OSR LAND
	SOLD OUT PLOTS
	UNSOLD PLOTS
	NOT TO BE REGULARISED

P.P.D (Regularisation NO : 1895
L.O 2017) 2019

APPROVED
VIDE LETTER NO : Reg.L/12600/ 2018
DATE : 31 / 10 / 2019

OFFICE COPY
FOR DEPUTY PLANNER
CHENNAI METROPOLITAN
DEVELOPMENT AUTHORITY

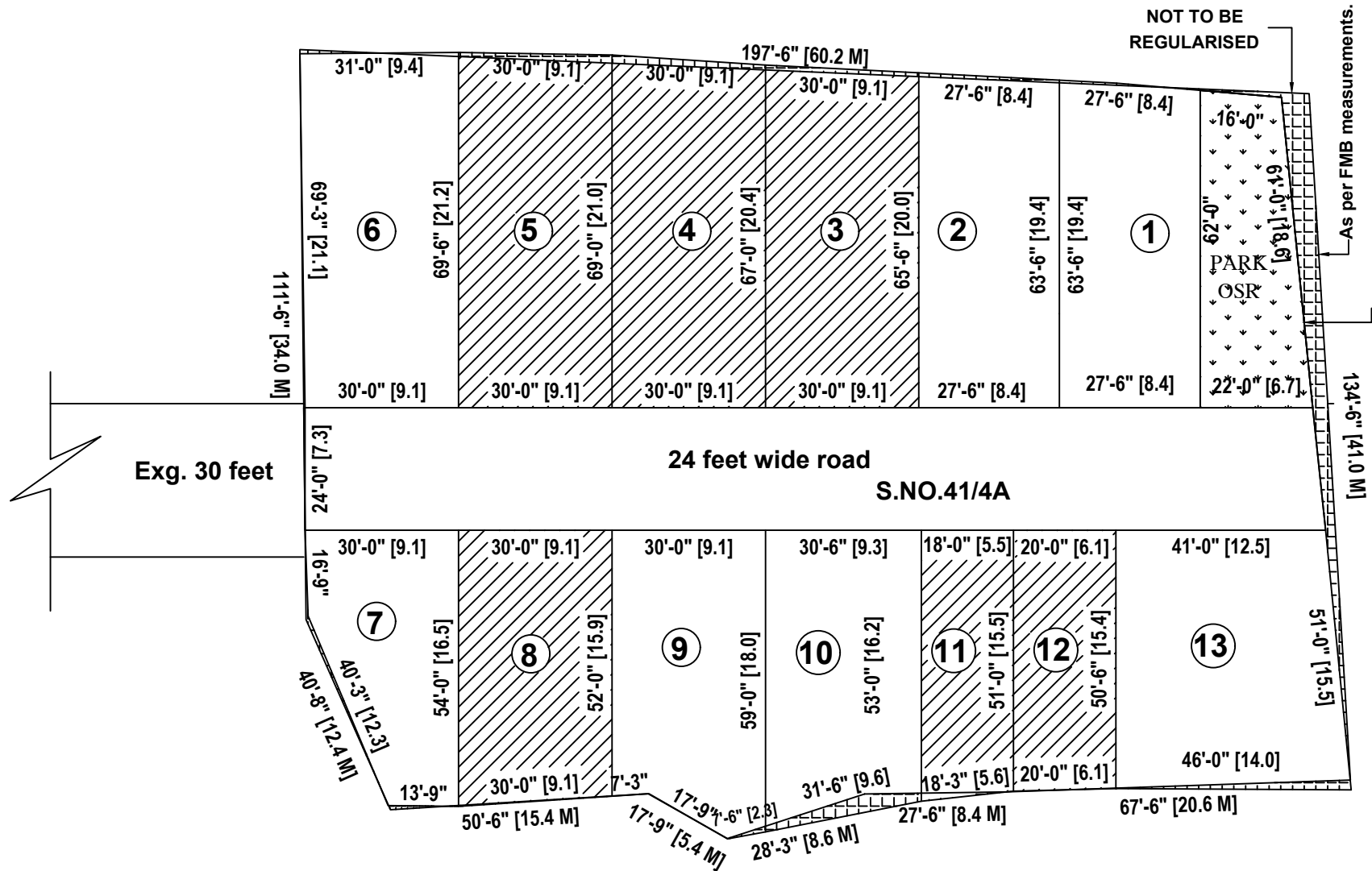

REGULARISATION OF LAYOUT FRAMEWORK IN S.NO.41/4A AT KUNDRATHUR VILLAGE OF KUNDRATHUR TOWN PANCHAYAT AS PER

G.O.(Ms).No.78 H & UD UD4 (3) DEPARTMENT DT.04.05.2017 AND G.O. (Ms). No. 172 H & UD(UD4 (3) dept. dated.13.10.2017

SCALE : 1" = 66' (ALL MEASUREMENTS ARE IN FEET)