

AREA STATEMENT

| | |
|--|-----------------------|
| TOTAL EXTENT | : 155543 SQ.FT |
| ROAD AREA | : 40605 SQ.FT |
| PLOTTABLE AREA | : 114938 SQ.FT |
| SOLD OUT AREA | : 2829 SQ.FT |
| UNSOLD AREA | : 112109 SQ.FT |
| 10% OF THE TOTAL AREA OF UN SOLD PLOTS REQUIRED FOR OSR | : 11211 SQ.FT |
| OSR PROVIDED PLOT NO'S RESERVED FOR OSR (51 to 59) | : 11333 SQ.FT |
| | : 09 Nos. |
| SOLD PLOTS | : 03 Nos |
| UN SOLD PLOTS | : 114 Nos |
| TOTAL NO. OF PLOTS | : 126 Nos |





NOTE:

- 1) A SPLAY AT THE INTERSECTION OF TWO OR MORE STREETS / ROADS SHALL BE PROVIDED AS PER DR 29.
- 2) ROAD AREA 40605 Sq.ft & PARK AREA 11333 Sq.ft GIFTED TO THE COMMISSIONER POONAMALLEE PANCHAYAT UNION VIDE GIFT DEED DOCUMENTS NUMBER 5431/ 2018 Dt 28.05.2018.

CONDITIONS:

- 1) As per G.O.(ms).no.78 H & UD UD4 (3) department dt. 04.05.2017 and G.O. (Ms). No. 172 H & UD(UD4 (3) dept. dated. 13.10.2017 the individual plot to be regularised separately after approval of lay out framework
- 2) only those unapproved layouts where a part or full number of plots have been sold through a registered sale deed as on 20 th October 2016 shall be Considered for regularization under these rules.
- 3) As per G.O.(Ms).No.172H & UD (UD4 (3) Dept dt. 13.10.2017 OSR charges are exempted for the plots sold on or before 20.10.2016.
- 4) Plot No:39 & 40 Future Plotting.

LEGEND

-  LAYOUT BOUNDARY
-  ROAD
-  PARK
-  SOLD PLOTS
-  UN SOLD PLOTS

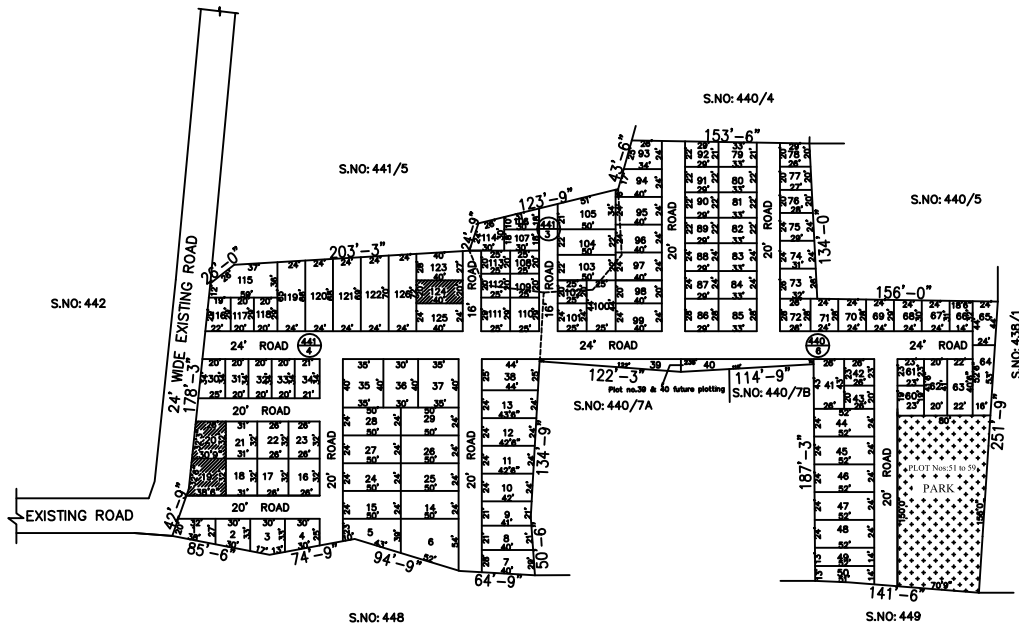

REGULARISATION OF LAYOUT FRAMEWORK IN S.Nos: 440/6,441/3&4 OF THIRUNINRAVUR 'B' VILLAGE OF POONAMALLEE PANCHAYAT UNION AS PER G.O.(Ms).No.78 H & UD UD4 (3) DEPARTMENT DT.04.05.2017 AND G.O. (Ms). No. 172 H & UD(UD4 (3) dept. dated.13.10.2017

SCALE : 1" = 66' (ALL MEASUREMENTS ARE IN FEET)

P.P.D (Regularisation NO : 726
L.O 2017) 2018

APPROVED

VIDE LETTER NO. : Reg. L / 3931 / 2018
DATE : / 05 / 2018

OFFICE COPY

FOR MEMBER SECRETARY
CHENNAI METROPOLITAN
DEVELOPMENT AUTHORITY

